



## Josephine Avenue, Brixton, SW2

2 bedroom flat - penthouse for sale

**£775,000**

Share of Freehold

### Property Details

A luxury two-bedroom, two-bathroom flat located on an extremely popular road. The property comprises a stunning loft-style, open-plan reception and kitchen with vaulted ceilings and double doors that open out onto a private balcony. The two double bedrooms are both a good size, the main bathroom is contemporary. Other selling points include a study area, a utility room and a generous square footage of 1100 square feet of internal space. Josephine Avenue is only three minutes from Brockwell Park, a ten-minute walk from Brixton tube station, and a ten-minute walk to Herne Hill station.

### Features

- Two double bedrooms
- Two bathrooms
- Study
- Penthouse apartment
- Chain-free
- Bright and airy throughout
- Sought after location
- Secure modern development
- Roof terrace

Council tax band E    EPC rating C (79)





Josephine Avenue, Brixton, SW2

**K**

2 Bed Flat.

Approx internal area:

**1100 sqft 102 sqm**

While we do try our very best, floor plans are produced as a guide only and we take no responsibility for the precise accuracy with which any property is represented

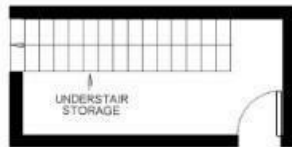

First Floor



Second Floor





Josephine Avenue, Brixton, SW2

